

REV.	DESCRIPTION	DATE

- Note:**
- Material:**
1. Housing: Nylon-66, UL94V-2.
  2. Color: Ivory-white.
  3. Terminal: Copper alloy. Tin-plated.

**Electrical:**

1. Current rating: 3A AC,DC
2. Voltage: 250V AC,DC
3. Contact resistance: 20mΩ Max
4. Insulation resistance: 1000MΩ Min
5. Temperature: -25°C ~ +85°C

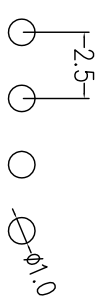
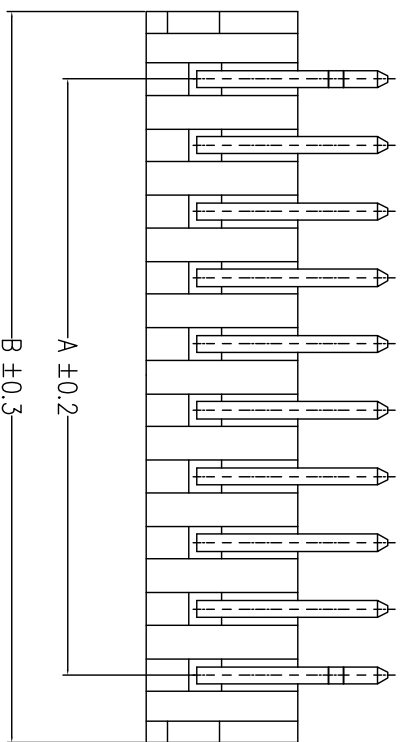

PCB Hole Layout

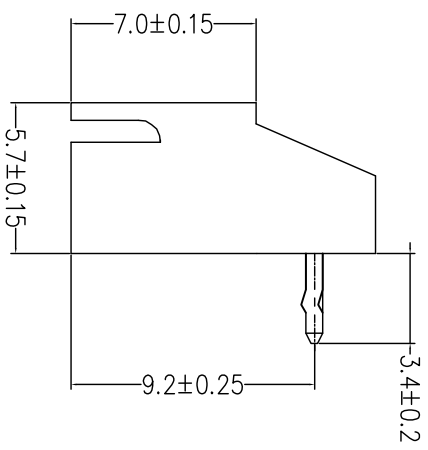
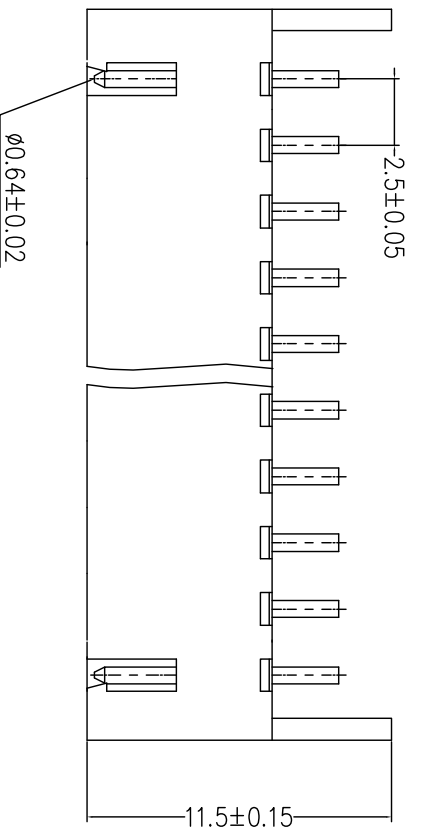

Circuits	Dimension mm		Circuits	Dimension mm	
	A	B		A	B
02	2.50	7.60	12	27.50	32.60
03	5.00	10.10	13	30.00	35.10
04	7.50	12.60	14	32.50	37.60
05	10.00	15.10	15	35.00	40.10
06	12.50	17.60	16	37.50	42.60
07	15.00	20.10	17	40.00	45.10
08	17.50	22.60	18	42.50	47.60
09	20.00	25.10	19	45.00	50.10
10	22.50	27.60	20	47.50	52.60
11	25.00	30.10			

<b>TOLERANCE</b> X ±X.XX XX ±X.XX XXX ±X.XX		<b>DRAWER</b> <i>Chiu Chiu Siao</i>	
<b>UNITS: mm</b> 		<b>CHECK</b> <i>Shi Tsung Siao</i>	
<b>DESIGNED</b> <i>Chiu Chiu Siao</i>		<b>NAME</b> 	
<b>APPROVAL</b> <i>Shaw Tsung Siao</i>		日亮電子科技有限公司 <i>Sun-Light Electronic Technologies Inc.</i>	
<b>DATE</b> 10/12/2011		<b>2.50mm Water 90°</b>	
<b>SCALE</b> FREE		<b>PART NO.</b> WTB-P25R-XX	
<b>SIZE</b> A4		<b>DRAW NO.</b> WTB-P25R	
<b>SHEET</b> 1 OF 1		<b>REV.</b> A	