

| REV. | DESCRIPTION | DATE |
|------|-------------|------|
| | | |
| | | |

Material:

- Housing: Nylon-66, UL94V-0.
- Terminal: Copper alloy, Tin-plated.

Electrical:

- Current rating : 1A AC,DC.
- Voltage rating : 100V AC,DC.
- Temperature range : -25°C to +85°C.
- Contact resistance: 20mΩ max.
- Insulation resistance: 500MΩ min.
- Withstanding voltage: 500VAC/minute.

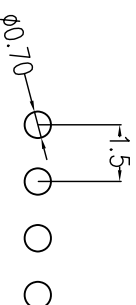
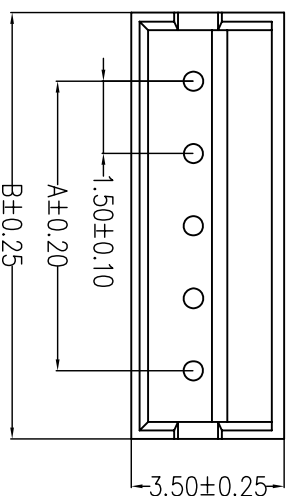
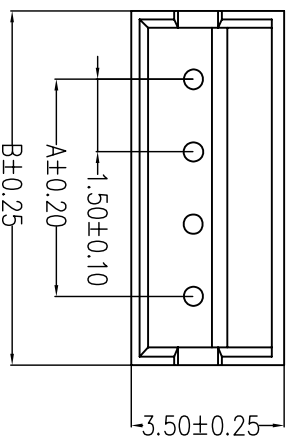

PCB Hole Layout

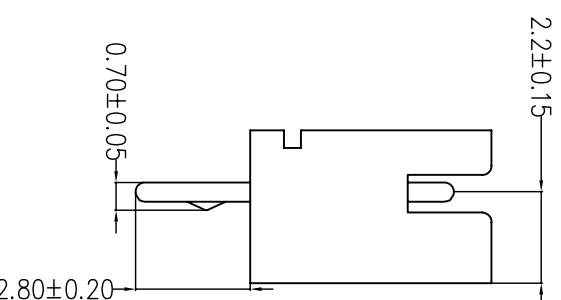

| Circuits | Dimensions | |
|----------|------------|--------|
| | A (mm) | B (mm) |
| 02P | 1.50 | 4.50 |
| 03P | 3.00 | 6.00 |
| 04P | 4.50 | 7.50 |
| 05P | 6.00 | 9.00 |
| 06P | 7.50 | 10.50 |
| 07P | 9.00 | 12.00 |
| 08P | 10.50 | 13.50 |
| 09P | 12.00 | 15.00 |
| 10P | 13.50 | 16.50 |
| 11P | 15.00 | 18.00 |
| 12P | 16.50 | 19.50 |
| 13P | 18.00 | 21.00 |

4PIN (含4PIN) 以下打K

5PIN (含5PIN) 以上打K

| | | | |
|---|--|--|--|
| <p>TOLERANCE X ±.20 XX ±.15 XXX ±.10</p> | | <p>DRAWER <i>Chiu Chuan Siau</i></p> | |
| <p>UNITS : mm</p> | | <p>CHECK <i>Shi Jeng Siau</i></p> | |
| <p>SCALE FREE</p> | | <p>DESIGNED <i>Chiu Chuan Siau</i></p> | |
| <p>SIZE A4</p> | | <p>APPROVAL <i>Shaw Jeng Siau</i></p> | |
| <p>PART NO. WTB-P15-XX</p> | | <p>NAME SynLight 日亮電子科技有限公司 <i>Sun-light Electronic Technologies Inc.</i></p> | |
| <p>DATE 12/01/2010</p> | | <p>1.5mm Wafer 180° 圓PIN針打K</p> | |
| <p>SHEET 1 OF 1</p> | | <p>DRAW NO. WTB-P15</p> | |
| <p>REV.</p> | | <p>REV.</p> | |