

REV.	DESCRIPTION	DATE

NOTE:

A. Material:

1. Housing : PC , UL94V-2 / UL94V-0.
2. Terminal : Copper Alloy.
3. Shielded : Brass.

B. Plating:

- 1.Terminal : Plating is based on 50u" Nickel Under Plating. Selective Gold Plated on Contact Touch Area.

2. Shielded : Nickel plated.

- C. Applicable Wire Gauge : 24~26AWG OD:5~6.5mm

- D. Operation Temperature : -40°C to 125°C

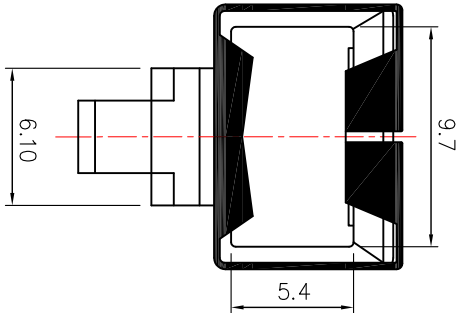
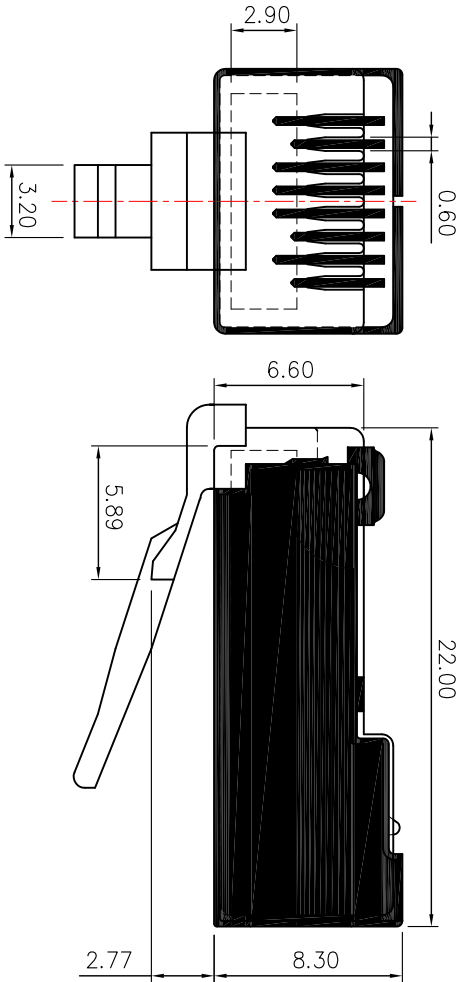
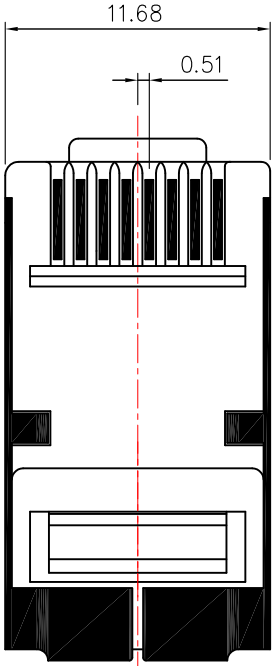

Round Cable

STD - C6A88X - R - XXu - DXV

Terminal Type :
1: 2 Prongs
3: 3 Prongs

Cable Type :
R: Round Cable

Plating Option :
6u"
15u"
30u"
50u"

Discern Type
UL94V-0

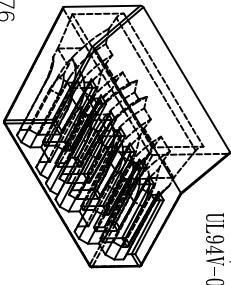
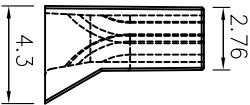
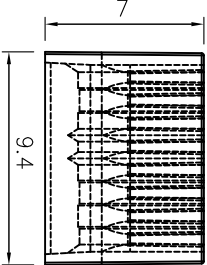

Insert Bar : MOD-C6A-DXV

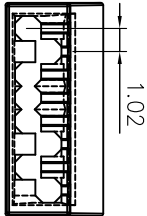

Color
UL94V-0

TERMINAL

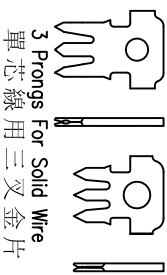
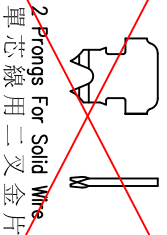
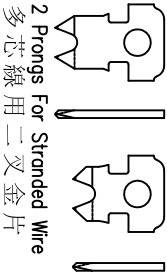

TOLERANCE
.X ±0.250
.XX ±0.150
.XXX±0.100



SCALE 3 : 1

DRAWER
CHECK
DESIGNED
APPROVAL
DATE

NAME
Modular Plug R445 Shielded 8P8C Cat-6A
Two-Piese Insert Bar Discern Type

PART NO.
STD-C6A88X-R-XXu-DX

DRAW NO.
STD-C6A88X-DX

SHEET 1 OF 1

REV. C